

SM10

Quick Manual

Ver.1.0

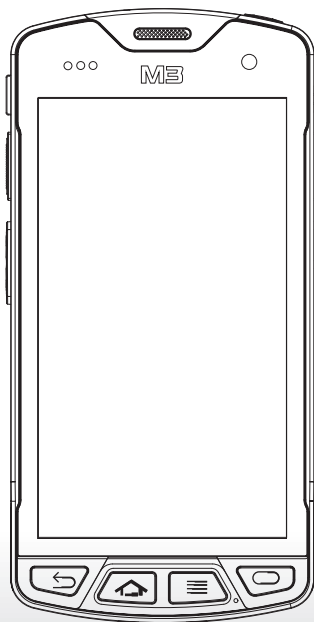

PACKAGE

- Please check all items below are included in package box.



< M3 SM10 >

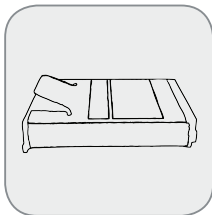

< Battery >

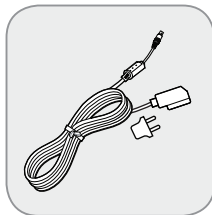

< Adaptor >



< Micro-USB Cable >

※ **Warning**

Use of controls or adjustments or performance of procedures other than those specified herein may result in hazardous radiation exposure.

DEVICE

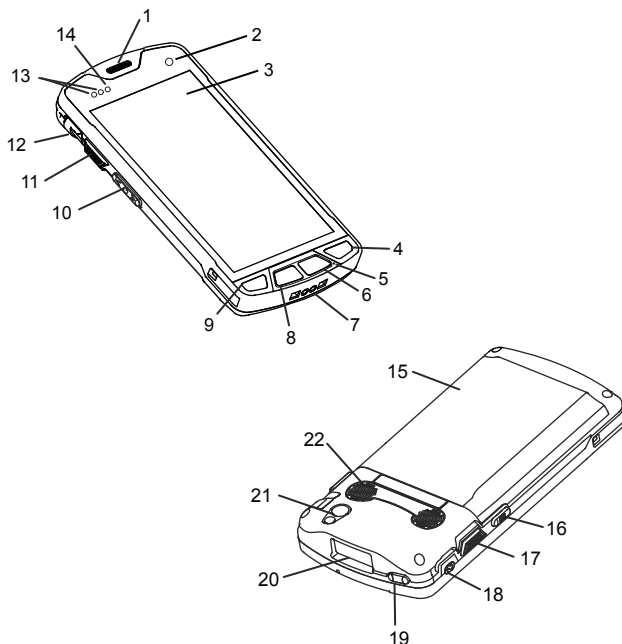

- | | | |
|----------------------|-------------------------|--------------------|
| 1. Receiver | 9. Back Button | 17. Scanner Button |
| 2. Camera | 10. Volume Button | 18. Ear Jack Hole |
| 3. Screen | 11. Scanner Button | 19. Power Button |
| 4. Function Button | 12. Micro-USB Connector | 20. Scan Window |
| 5. Microphone | 13. Sensor | 21. Camera |
| 6. Menu Button | 14. Charging LED | 22. Speaker |
| 7. Charging Contacts | 15. Battery Cover | |
| 8. Home Button | 16. Camera Button | |

KEYPAD

• Button

Button	Description
Scanner	Operate the scanner while executing the scanner program.
Volume High	Increase the volume.
Volume Low	Decrease the volume.
Camera	Take pictures while executing the camera program.
Back	Return to the previous stage.
Home	Go to the Home screen.
Menu	Display the menu.
Action	Execute the work set to the button.

• Home Screen

If the device is turned on, the following screen will be displayed.

The screen is divided into four sections as follows:

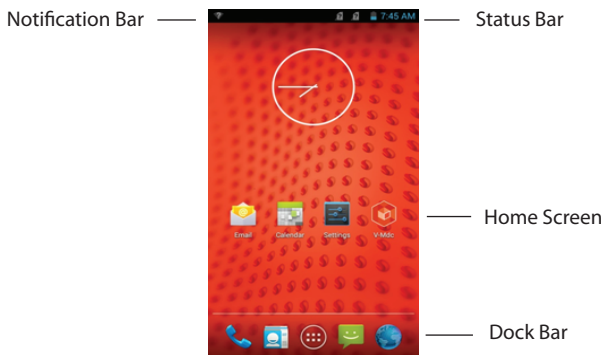

SOFT RESET (1)

Press and hold the Power button to display the power management menu. Select the "Power Off and Restart" menu.

SOFT RESET (2)

If the device stops its operation for a long time, press the Volume Down button + the Back button + the Camera button to perform soft reset. The program being executed will end, and the data or file being used will also be deleted. However, the stored data or file will not be affected by the soft reset.

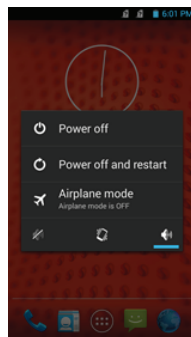

FACTORY DATA RESET

If a serious problem occurs in the device or a problem is not resolved through soft reset, perform factory reset. According to the options, the document in the internal SD card or the Micro-SD card may be deleted. As such, please check the options. All settings will be reset.

For factory reset, perform the following procedure.

- Tap  → Backup & reset → Factory data reset
- Check if Erase internal SD-Card is checked → Reset Phone → Erase everything

CARD INSTALLATION

Inserting the SIM Card

- To insert the SIM card, remove the battery cover on the rear of the device and pull out the battery.
- Either the front or back of the SIM card can be connected to the dual slot.

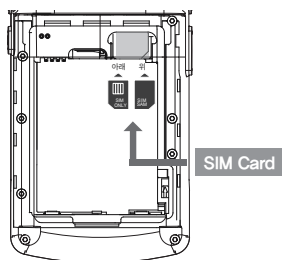

Inserting an External Memory Card

- The Micro-SD card is used as an external memory of M3 SM10.
- After removing the battery, insert the SD memory card into the Micro-SD card slot.

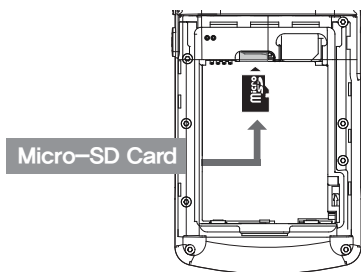

BATTERY

Inserting the Battery

- Insert the battery from the bottom in the right direction.
- After inserting the battery, slide the Slide button to the left to fix the locking device.

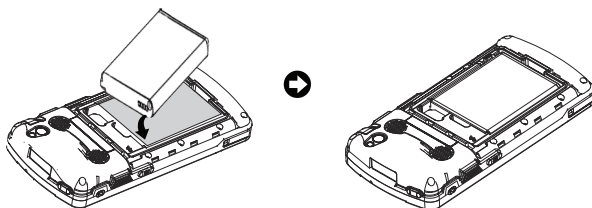

Removing the Battery

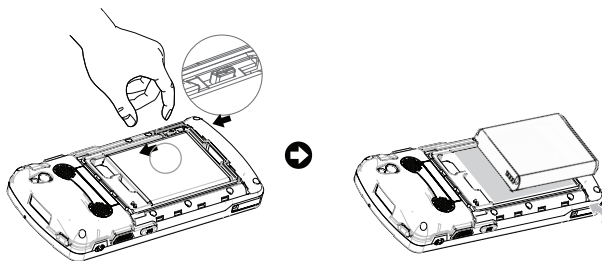

※ **Caution**

- If an unapproved battery is used, it may explode.
- Check if the battery is inserted in the right direction.

CHARGING

Charging the Battery

- Use a portable adaptor to connect with the micro-USB port to supply external power.
- Alternatively, you may connect the device to a cradle that you can additionally purchase to charge the battery.

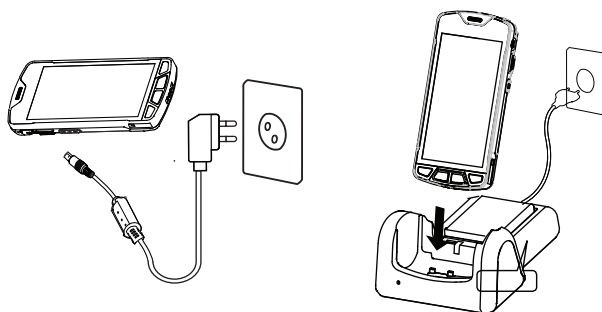

LED Color	Description
Red	Battery is being charged.
Green	Battery is fully charged.

※ **Caution**

Use only an M3 Mobile-approved adaptor. If not, the device may malfunction or be damaged during or after its charging, or the battery performance may degrade.

SCANNER

Place the device toward to the barcode desired, and press the Scan button.

The laser beam of the scanner should completely cover the bar code as shown in the following.



O



X

<1D Scanner>



O



X

<2D Scanner>

※ **Warning**

*Do not look at the laser beam directly.
(Class 2 Laser product 1.0 mW, Max Output: 650 nm)*

*If the device is used for purposes other than that described in this manual,
a user may be exposed to harmful electromagnetic waves.*

NFC

Connecting with the NFC Device

- Open a Web page or the screen of a video, photo, or contact.
- Place the back part of the NFC device toward the back of the M3 SM10.
- Touch the screen. Data transfer would then start.

Connecting to the NFC Chip / Tag Card

- Hold the M3 SM10 as shown below. Do not cover the antenna area of the battery cover with your hands.
- Place the M3 SM10 near the NFC chip or tag card until the data transfer is completed. (Generally, data is displayed in the application.)

CAMERA

Taking pictures

- Run the Camera program.
- Tab the Capture button to take a picture.

Taking videos

- Run the Camera program.
- Tab the Video Mode button to take a video.

※ **Warning**

It may cause significant damages to your eyes if you directly look the flash attached at camera module.

OS UPDATE

The M3 Mobile can distribute a new OS to improve the quality and performance of a product.

The latest OS is described in the online support page of M3 Mobile. The OS of M3 SM10 can be updated through two methods:

- i. Use the Micro-SD card.
- ii. Connect the device through USB cable.

For detailed information on OS update, please refer to the the "OS" item of the M3 FAQ (FAQ download).

TECHNICAL SUPPORT

Should you require any services or technical support on M3 Mobile's products, contact your supplier or visit M3 Mobile technical support web page.

Technical Support Website: <http://itc.m3mobile.net>

Desired or relevant manuals can be downloaded from Manuals or FAQ in technical support webpage. User manual, especially, is included in Flash Disk so that M3 T users can obtain it from the Flash Disk as well.

For DOA or RMA, please send the defective product to suitable address AFTER consulting the supplier.

M3 MOBILE

Your Best Mobile Business Partner

Headquarter

M3 bldg., 735-45,
Yeoksam-Dong, Gangnam-gu,
Seoul, 135-080, Korea
Tel: +82 2 574 0037 (Ext.4)
Fax: +82 2 556 0155
www.m3mobile.net
sales@m3mobile.co.kr

Production Center/Service Center

Chun-ui Techno Park 2, 1-604,
Chunui-Dong, Wonmi-Gu,
Bucheon, Gyunggi-Do,
420-857, Korea
Tel: +82 32 623 0037
Fax: +82 70 4015 6323